

WAVE

Climate change results not only in rainwater issues but also in heatstress and long periods of drought. The patterns of the Rain(a)Way Wave-tiles create a lot of design possibilities and make de-tiling and intensive greening possible.

The Wave-tiles enables infinite variations in patterns, ranging from an open to a closed surface. This creates design possibilities for a unique result and makes the scope for application wide. The patterns vary from completely closed to 37% open surface. Rainwater can infiltrate through the open surfaces to the ground. There are different options to fill the open spaces such as gravel or green. This way you use rainwater as a quality for a pleasant and healthy living space.

Main benefits

- Stores and infiltrates rainwater
- Sustainable contributor to solving effects of climate change
- Perfect for intensive green
- Design freedom because of different patterns
- Save material and costs with an open pattern
- 100% reusable material
- Make every project unique by combining patterns
- Long durability

The Wave-tile uses rainwater for a pleasant and healthy living space.

Conditions for application

A special substrate has been developed to fill the open spaces in the tiles. It infiltrates perfectly and is suitable for different plantgroups. The Wave-tile can be combined with a range of different foundations, substrates and fillings. Please contact us for more information.



Wave shells

Wave stone

Colours

The colours displayed below are the standard colours. Varying in colours is possible: do not hesitate to contact us.

Sizes

38 x 38 x 8 cm

A 16,7 kg

B 24,6 kg

Material

Concrete

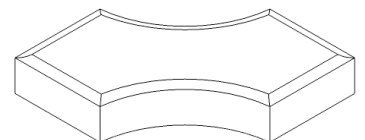

A

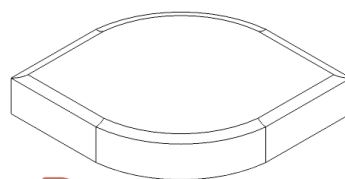

B



“Rain(a)Ways strengths are their designs, esthetic, sustainability and their advice on application per location.”

- Rob Verdonshot, Swaans Beton

Rain(a)Way
Galileistraat 2
5621 AE EINDHOVEN

Info@rainaway.nl
www.rainaway.nl

rain  way

Powered by  **SWAANS**
BETON